

**Fitment Instructions****Model: SUZUKI
Grand Vitara****Underbody Protection Plate****Part number: IUP011T****Transmission****Years: 2005-****Engine type: all (1.6,1.9, 2.0, 2.4, 3.2 V6)****APPLICATION:**

Protection of engine bay and transmission elements from damage.
Protection of engine bay and transmission elements from dust and water.

INSTALLATION:

This protection plate has been designed for installation to the intended application only. It should be mounted according to these installation instructions by an experienced Ironman 4x4 dealer or certified fitter. The plate is fixed to original vehicle mountings located on the vehicle's body load-bearing elements. Upon successful installation the plate should not interfere with any other parts or components.

INSTALLATION MANUAL:

1. The plate is to be installed after mounting the plate for engine bay.
2. Install the rear drop bracket, place one end under the fuel pump OE bolt, fix the other end to the vehicle with an M8x20bolt.
3. Mount threaded inserts to the transmission's beam.
4. Install the front of plate "A" to the engine bay plate, and the rear to the transmission beam.
5. Install the front of plate "B" to the rear of part "A" incorporating the transmission beam and threaded inserts.
6. Tighten all screw joints.

WARRANTY:

Warranty period - 12 Months

WARRANTY TERMS:

The plate should only be installed on a vehicle with undamaged body and load-bearing elements, vehicles which have been involved in a significant collision may prevent successful installation.

Ironman 4x4 does not bear liability for any damages caused to the vehicle, or injury to persons in case of installation or product failure. Ironman 4x4 has a right to introduce changes into the skid plate construction.



The Quality Management System at production has been audited by Bureau Veritas Certification and conforms to requirements of the ISO 9001:2008 standard.

www.ironman4x4.com

**IRONMAN 4X4
MELBOURNE SHOWROOM**
Cnr Centre & Westall Roads,
Clayton, Victoria 3168
Telephone +61 3 9532 1111

**IRONMAN 4X4
BRISBANE SHOWROOM**
1 Hinkler Court
Brendale, QLD, 4500
Telephone (07) 3482 9500

**IRONMAN 4X4
PERTH SHOWROOM**
Unit 9/511 Abernethy Road
Kewdale, WA, 6105
Telephone (08) 6254 4444

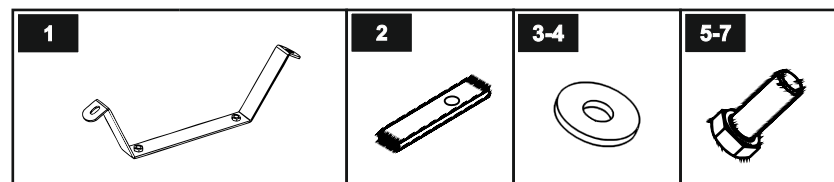
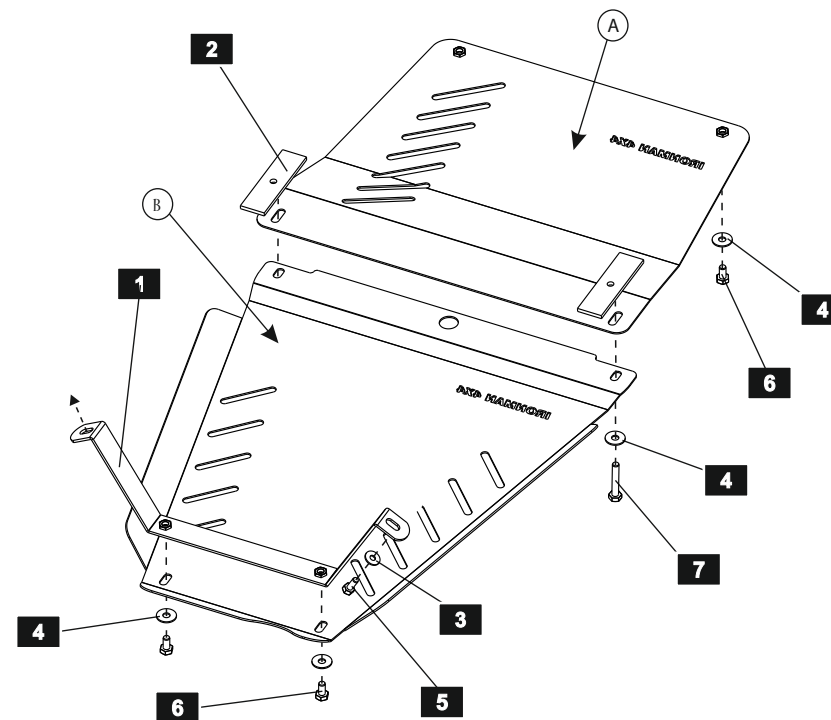
**LIST OF PARTS**

NO.	NAME	QTY.	NO.	NAME	QTY.
1	Rear drop bracket	1	5	Bolt M 8x20	1
2	Threaded insert	2	6	Bolt M 10x20	4
3	Washer 8	1	7	Bolt M 10x60	2
4	Washer 10	6	8		

Thread	M6x1.0	M8x1.25	M10x1.5	M12x1.75
Tightening torque	9.8 Nm	24.0 Nm	47.0 Nm	81.0 Nm