

**Fitment Instructions****Model: MITSUBISHI Triton / Challenger****Underbody Protection Plate****Part Number: IUP010T****Transmission****Years: 2006-****Engine type: 2,5TD****APPLICATION:**

Protection of engine bay and transmission elements from damage.  
Protection of engine bay and transmission elements from dust and water.

**INSTALLATION:**

This protection plate has been designed for installation to the intended application only. It should be mounted according to these installation instructions by an experienced Ironman 4x4 dealer or certified fitter. The plate is fixed to original vehicle mountings located on the vehicle's body load-bearing elements. Upon successful installation the plate should not interfere with any other parts or components.

**INSTALLATION MANUAL:**

1. This plate is intended to be installed together with the engine bay plate.
2. Install brackets "2" and "3", fixing them under the transmission beam OE bolts.
3. Mount combined bracket "1" on the subframe's right side. Don't tighten the bolts.
4. Unscrew transfer case mounting nut, then mount lug "5" on the thread pin of support.
5. Bracket "4" is only used for vehicles without transfer case support. The bracket is to be fixed to the subframe's OE points, after which lug "5" should be installed.
6. Install the front of the transmission plate with the rear of the engine bay plate using threaded inserts.
7. Tighten all screw joints.

**WARRANTY:**

Warranty period - 12 Months

**WARRANTY TERMS:**

The plate should only be installed on a vehicle with undamaged body and load-bearing elements, vehicles which have been involved in a significant collision may prevent successful installation.

Ironman 4x4 does not bear liability for any damages caused to the vehicle, or injury to persons in case of installation or product failure. Ironman 4x4 has a right to introduce changes into the skid plate construction.

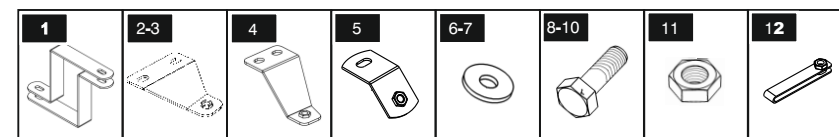
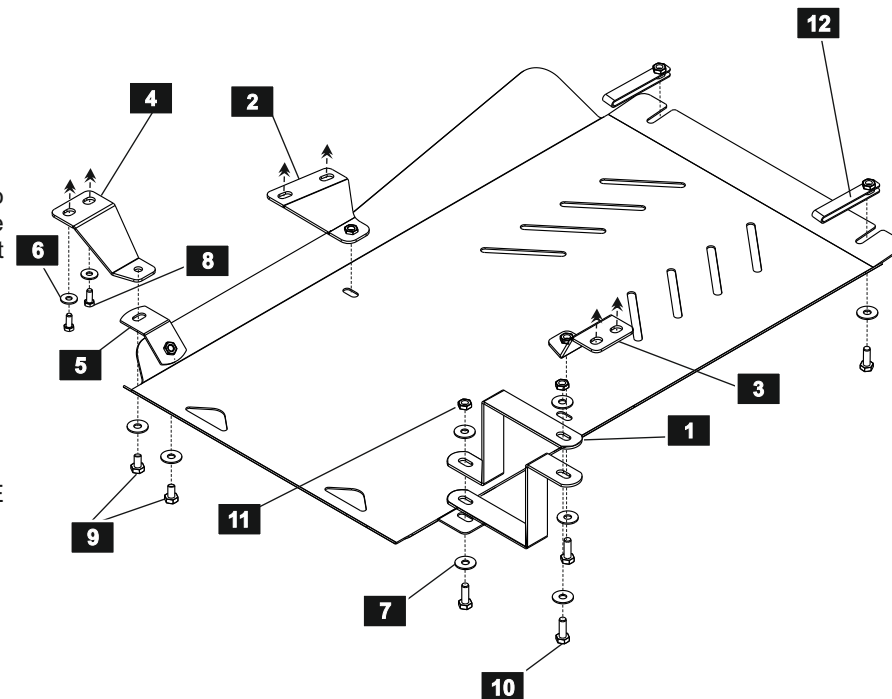
**LIST OF PARTS**

NO.	NAME	QTY.	NO.	NAME	QTY.
1	Combined Bracket	2	7	Washer 10	10
2	Left Bracket	1	8	Bolt M8x20	2
3	Right Bracket	1	9	Bolt M10x20	2
4	Bracket	1	10	Bolt M10x30	6
5	Lug	1	11	Nut 10	2
6	Washer 8	2	12	Threaded insert	2
Thread		M6x1.0	M8x1.25	M10x1.5	M12x1.75
Tightening torque		9.8 Nm	24.0 Nm	47.0 Nm	81.0 Nm



The Quality Management System at production has been audited by Bureau Veritas Certification and conforms to requirements of the ISO 9001:2008 standard.

[www.ironman4x4.com](http://www.ironman4x4.com)

**IRONMAN 4X4**  
**MELBOURNE SHOWROOM**  
Cnr Centre & Westall Roads,  
Clayton, Victoria 3168  
Telephone +61 3 9532 1111

**IRONMAN 4X4**  
**BRISBANE SHOWROOM**  
1 Hinkler Court  
Brendale, QLD, 4500  
Telephone (07) 3482 9500

**IRONMAN 4X4**  
**PERTH SHOWROOM**  
Unit 9/511 Abernethy Road  
Kewdale, WA, 6105  
Telephone (08) 6254 4444