



Fitment Instructions

Model: Mitsubishi Triton ML / L200

Underbody Protection Plate

Part Number: IUP010E

Engine Bay

Years: 2006 -

Engine type: 2,5 TD

APPLICATION:

Protection of engine bay and transmission elements from damage.
Protection of engine bay and transmission elements from dust and water.

INSTALLATION:

This protection plate has been designed for installation to the intended application only. It should be mounted according to these installation instructions by an experienced Ironman 4x4 dealer or certified fitter. The plate is fixed to original vehicle mountings located on the vehicle's body load-bearing elements. Upon successful installation the plate should not interfere with any other parts or components.

INSTALLATION MANUAL:

1. Disassemble the plate and check all received components
2. Remove original vehicle duster.
3. Install front of plate "1" to the vehicle
4. Loosely install the rear of plate "1" to the vehicle.
5. Insert plate "2" under the fastening of plate "1" and fix the rear of the plate to the crossbar using the threaded inserts.
6. Tighten all screw joints.

WARRANTY:

Warranty period - 12 Months

WARRANTY TERMS:

The plate should only be installed on a vehicle with undamaged body and load-bearing elements, vehicles which have been involved in a significant collision may prevent successful installation.

Ironman 4x4 does not bear liability for any damages caused to the vehicle, or injury to persons in case of installation or product failure. Ironman 4x4 has a right to introduce changes into the skid plate construction.

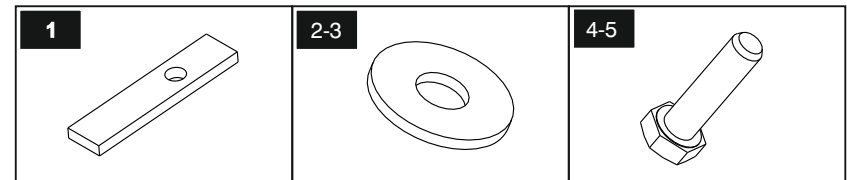
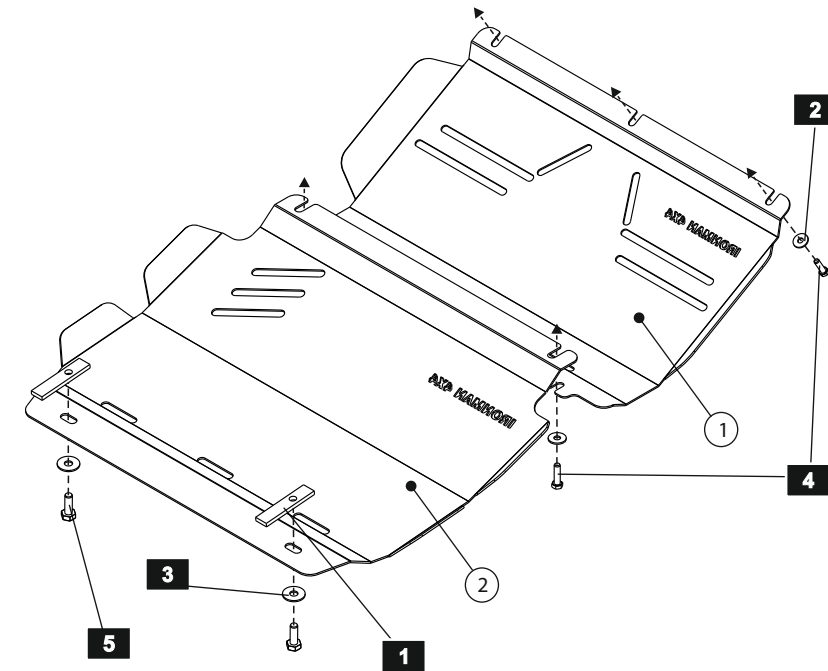

LIST OF PARTS

NO.	NAME	QTY.	NO.	NAME	QTY.
1	Threaded insert	2	5	Bolt M10x30	2
2	Washer 8	5	6		
3	Washer 10	2	7		
4	Bolt M8x30	5	8		

Thread	M6x1.0	M8x1.25	M10x1.5	M12x1.75
Tightening torque	9.8 Nm	24.0 Nm	47.0 Nm	81.0 Nm



The Quality Management System at production has been audited by Bureau Veritas Certification and conforms to requirements of the ISO 9001:2008 standard.

www.ironman4x4.com

**IRONMAN 4X4
MELBOURNE SHOWROOM**
Cnr Centre & Westall Roads,
Clayton, Victoria 3168
Telephone +61 3 9532 1111

**IRONMAN 4X4
BRISBANE SHOWROOM**
1 Hinkler Court
Brendale, QLD, 4500
Telephone (07) 3482 9500

**IRONMAN 4X4
PERTH SHOWROOM**
Unit 9/511 Abernethy Road
Kewdale, WA, 6105
Telephone (08) 6254 4444